

548-e

Weighing & Dosing Controller, Type BUCODAT-3

- For one to max. three Scales
- Each Scale with max. 8 Components, as option extendable
- With large Memory for Formulae, Material Components and further Parameters
- Input of Datas and Calibration with a 20-key Foil Keyboard
- Operating Information (Actual Weight, Nominal Weight, Step No., Component No., Batch No., etc.) and User Guides for Data Input (Scale Constants, etc.) are monitored by 2-line LCD-Displays (each line with 20 characters, 8 mm high)
- With Serial Interface Port RS232 (usable for connection with printer or PC)
- With potential free Relay Contacts for Output Signals (e.g. Programme End, Scale Empty, Coarse Dosing, Fine Dosing, etc.); An additional PLC is not required
- With Signal Inputs for up to 4 Load Cells of 350 Ohms (8 Load Cells of 700 Ohms) for each Scale
- Power Supply: 220 – 240 V, 50 – 60 Hz, 0.5 A
- Dimensions: Rack 19", 3 HU, see also Drawing down below

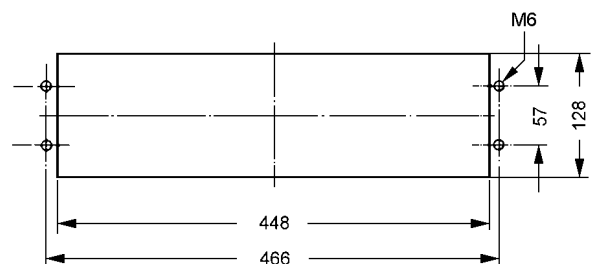
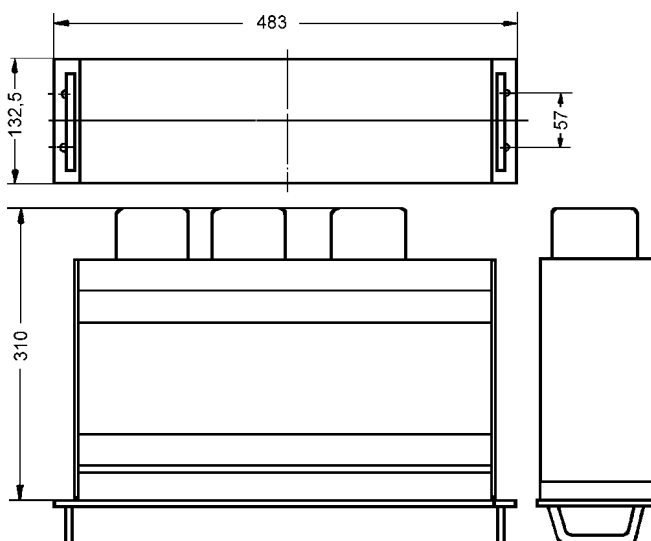
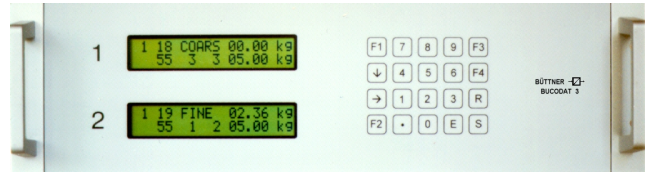

Schalttafelanschluss für Geräteeinschub Bucodat-3, 19", 3 HE
Control Panel Dimensions for Subrack Bucodat-3, 19", 3 HU

Aussenabmessungen des Geräteeinschubs Bucodat-3 (19", 3 HE)
Outer Dimensions of Subrack Bucodat-3 (19", 3 HU)